

LIVING ROOM

Lundia

Created by Nature

FULLY ADJUSTABLE MODULAR SHELVING & STORAGE

STORAGE,
DISPLAY &
WORK SPACES

**TALK TO US
TODAY**



Living Room Showroom & Workshop | 65 Kaiwharawhara Road | PO Box 9009, Wellington 6141
phone +64 4 473 9030 | sales@livingroom.co.nz | www.livingroom.co.nz

CONTENTS

Uprights	2	Wine Racks.....	6
Shelves	2	Hanger Rails	6
Bracing, Pins, Brackets & Clamps.....	3	Footrests.....	6
Backs.....	3	Pamphlet Units	7
Accessory Shelves.....	4	Poster Units	7
Adjustable Workslides.....	4	Drawer Units.....	7
Upright Tenons & Capping.....	5	Ecoboxes	8
Benchtops.....	5	Doors	8
Toekicks, Pelmet & Binfronts.....	6		

PRICING

Pricing is subject to change and is therefore not included in this booklet. The quote we will provide you with includes GST. Local delivery and installation will be itemised. Options can be priced for different finishes including raw pine, clear lacquer, stain and paint.

DELIVERY & INSTALLATION

Lundia shelving comes flat packed and some assembly is required. Basic units come with instructions, however for larger units we can include costs for delivery and installation in your quote.

SHELVING DESIGN

We are Lundia specialists and offer a free design service to provide shelving and storage ideas to suit your space. Please don't hesitate to contact us. Visit www.livingroom.co.nz to see photos of shelving we have designed and installed in the Wellington area. Please note Lundia does not make bookshelf ladders.



Specification and pricing is subject to change without notice. Additional accessories are available. Please contact Living Room for details. Phone 04 473 9030 or sales@livingroom.co.nz

OPEN UPRIGHTS are available in any combination of the following sizes:

Height in mm

437 | 512 | 762 | 915 | 1220 | 1524 | 1829 | 2100 | 2400 | 2745 | 3048 | 3353 | 3658

Depth in mm

235 | 292 | 381 | 457 | 610 | 762

- Open uprights are drilled through so that shelves can be added on both sides.
- All uprights are drilled at 50.4mm spacings as standard but can also be drilled at 25.2mm.

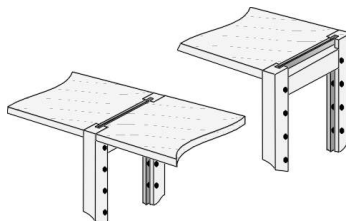

PANELLED UPRIGHTS with solid sides in either **4mm MDF or ply** are available in any combination of the following sizes:

Height in mm

512 | 762 | 915 | 1220 | 1524 | 1829 | 2100 | 2400 | 2745 | 3048

Depth in mm

235 | 292 | 381 | 457 | 610 | 762

- Panelled uprights close the unit off. Shelving cannot be added on closed side.
- Intermediate panelled uprights have a panel in the centre with grooves and drilling to allow shelves to be added on both sides.

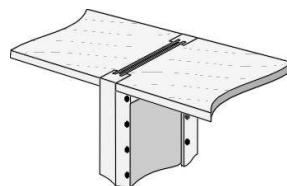
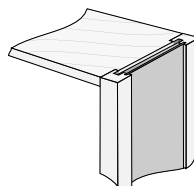

SHELVES made from **18mm pine** are available in the following sizes:

Width in mm

455 | 600 | 800 | 900 | 1000 | 1200

Depth in mm

235 | 292 | 381 | 457 | 610 | 762

- Long and narrow shelves may bow when loaded. Shorter lengths are recommended.
- Linen cupboard / slotted shelves are also available.

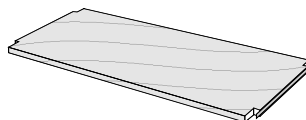

Specification and pricing is subject to change without notice. Additional accessories are available. Please contact Living Room for details. Phone 04 473 9030 or sales@livingroom.co.nz

CROSS BRACES are available in black or white and are supplied with screws. Each cross brace will hold up to 3 bays.

OPEN BRACES hold up to 2 bays.

SHELF PINS are supplied with all shelves. 25mm for open/end uprights, 20mm pins for intermediate panelled uprights and 45mm pins for display lip shelves.

WALL BRACKETS are recommended for units 1500mm tall and above. They are available in 80mm and 300mm lengths. Top hat wall brackets secure the end of the bracket to the wall and can be used instead of cross braces.

CONNECTING CLAMPS need to be fitted to all back to back units (except where joined by end covers) with 2 per join on units 2745mm tall or less, and 3 per join on taller units.



Cross-Brace

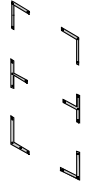

Open Brace Set

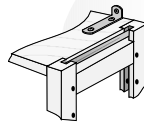

Wall Bracket

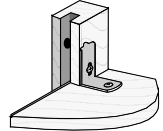

Anti-tilt Bracket

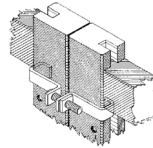

Connecting Clamp

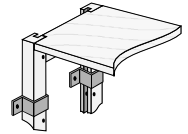

Top Hat Wall Bracket

BACKS made from **4mm MDF or pine ply** are available in the following sizes:

Width in mm

455 | 600 | 800 | 900 | 1000 | 1200

Height in mm

512 | 762 | 915 | 1220 | 1524 | 1829 | 2100 | 2400

BACKS made from **9mm MDF** are available in the following sizes:

Width in mm

455 | 600 | 800 | 900 | 1000 | 1200

Height in mm

1524 | 1829 | 2100 | 2400

Specification and pricing is subject to change without notice. Additional accessories are available. Please contact Living Room for details. Phone 04 473 9030 or sales@livingroom.co.nz

ACCESSORY SHELVES WITH SLOPING DISPLAY LIP are available in the following sizes:

Width in mm

455 | 600 | 800 | 900

Depth in mm

235 | 292 | 381 | 457 | 610 | 762

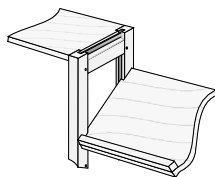

For angled shelf order next standard size up eg. 381 shelf in 292 upright

EXTENDED ACCESSORY SHELVES are available in the following sizes:

Width in mm

455 | 600 | 800 | 900 | 1000

Depth in mm

292 (+165) | 381 (+169)

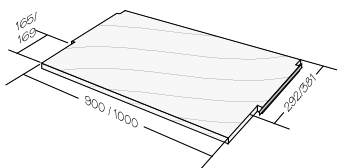

- When used with computer it is recommended that a pull-out keyboard slide be used as these shelves may not provide the depth required.
- Use a pair of anti-tilt brackets at rear.

PULLOUT ADJUSTABLE WORKSLIDES for keyboard and reference are **381mm deep** and are in the following widths:

Width in mm

500 | 700 | 800 | 900 | 1100

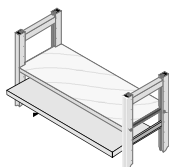

*Pullout keyboard has **adjustable clearance** under shelf for keyboard*

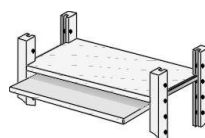

*Pullout reference has **minimal clearance** under shelf, maximising storage*

SCALLOPED ACCESSORY SHELVES are available in the following sizes:

Width in mm	Depth in mm		
800	292	381	-
900	292	381	457
1000	292	381	457

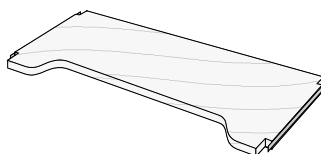

Specification and pricing is subject to change without notice. Additional accessories are available. Please contact Living Room for details. Phone 04 473 9030 or sales@livingroom.co.nz

CORNER ACCESSORY SHELVES are available in the following sizes:

Width in mm	Depth in mm	
500	235	457
600	292	610
800	381	762

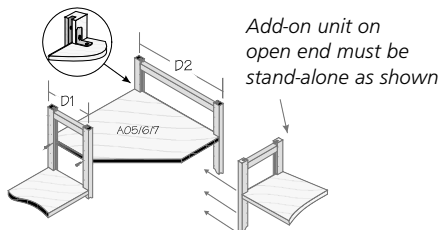
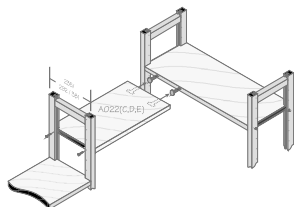

LOCK-ON ACCESSORY SHELVES are available at 400mm length and depths of 235mm, 292mm and 381mm. 'T' shape groove is drilled to the underside of the shelf and they can be made as left or right hand.

UPRIGHT TENONS & CAPPING comes in the following sizes:

Adjustable upright tenons (depth in mm)	Split uprights (depth in mm)	Upright capping (depth in mm)
235	235	235
292	292	292
381	381	381
457	457	457
610	610	610
762	762	-

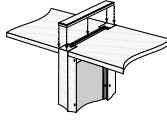
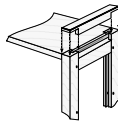
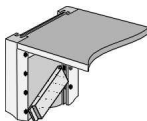
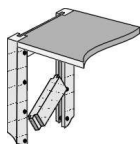

- These suit open uprights and come supplied with pins.
- Upright capping can be used on open, intermediate and panelled uprights.

BENCHTOPS are available in the following sizes. Talk to us about Melteca colour options. All benchtops come supplied with screws.

Description/Material	Maximum size (mm)
Pine 18mm	3000w x 1000d
MDF 18mm	2400w x 1200d
Melteca 25mm	2400w x 1200d

Specification and pricing is subject to change without notice. Additional accessories are available. Please contact Living Room for details. Phone 04 473 9030 or sales@livingroom.co.nz

TOEKICKS, PELMETS & BINFRONTS come in the following sizes and are supplied with the necessary installation hardware.

Width in mm

455 | 600 | 800 | 900 | 1000 | 1200

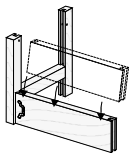

Toekick

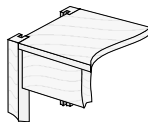

Pelmet

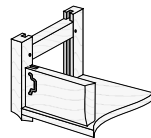

Binfront

WINE RACKS are available in the following sizes:

Description/Size	Shelf Width (mm)
5 Scallops	455
6 Scallops	600
8 Scallops	800
9 Scallops	900
10 Scallops	1000
12 Scallops	1200

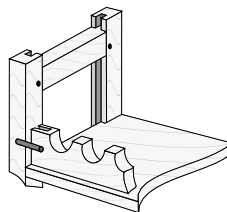

HANGER RAILS are available in the following sizes:

Bay width in mm

455 | 600 | 800 | 900 | 1000 | 1200

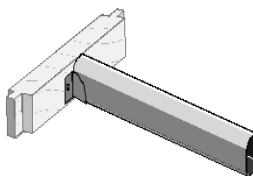

2 tenons are required for fastening and are sold separately.

FOOTRESTS in **timber** are available in the following sizes:

Width in mm

600 | 800 | 900 | 1000 | 1200

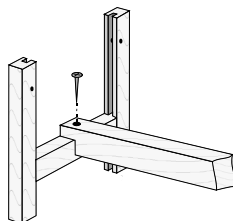

Specification and pricing is subject to change without notice. Additional accessories are available. Please contact Living Room for details. Phone 04 473 9030 or sales@livingroom.co.nz

PAMPHLET UNITS are available in the following sizes:

Size of Unit (mm)	Number of Bays
870w x 428h x 381d (fits 900 wide bay)	3 bays at 266mm wide 11 slots per bay
770w x 428h x 292d (fits 800 wide bay)	3 bays 230mm wide 11 slots per bay

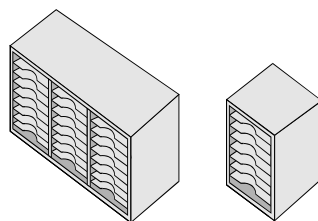

POSTER UNITS are available in the following sizes:

Size of Unit (mm)	Number of Slots
868w x 650h x 609d	10
1168 x 650h x 609d	10

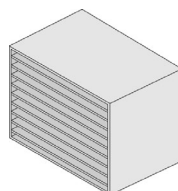

*9mm slides
can be pulled
out to view
contents*

PULLOUT POSTER UNITS can be made to order, based on 610mm shelf depth.

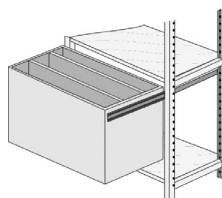

DRAWER UNITS are available in **381mm** or **457mm** depths at the following sizes:

Description	Width (mm)	Dimensions of cabinet (mm)
Single Height One Drawer	600	568w x 215h
Single Height One Drawer	800	768w x 215h
Single Height Two Drawers (side by side)	1000	968w x 215h
Double Height One Drawer	600	568w x 330h
Double Height One Drawer	800	768w x 330h
Double Height Two Drawers (side by side)	1000	968w x 330h
Double Height Two Split Drawers	600	568w x 330h
Double Height Two Split Drawers	800	768w x 330h
Double Height Four Split Drawers (side by side)	1000	968w x 330h

Specification and pricing is subject to change without notice. Additional accessories are available.
Please contact Living Room for details. Phone 04 473 9030 or sales@livingroom.co.nz

ECOBXES are made from 18mm pine and are available in 4 complementary sizes which stack vertically or horizontally. Customers can design their own configuration to best suit their space, their storage needs and their own individual style.

They come in **Natural Pine, Clear Lacquer, White Colour Wash** or **Black/Dark Stain**. They are also available in a range of Melteca colours. They have a depth and height of 380mm and come in the following widths:

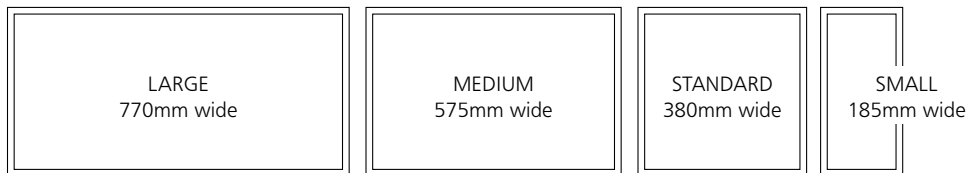

SOLID DOORS are available in pine or painted MDF. They are available in the following sizes. We can discuss with you the number of doors required and their widths, once the size of the unit is established.

Width in mm

455 | 600 | 800 | 900 | 1000 | 1200

Height in mm

762 | 915 | 1220 | 1524 | 1829 | 2100 | 2400